



# Brainerd Industrial Park

[bladc.org](http://bladc.org)

ABOUT US | AREA ECONOMY | BUILDINGS/LAND | WORKFORCE | FINANCING | INFRASTRUCTURE | QUALITY OF LIFE

## Brainerd Industrial Park

### SITE PROFILE

Available: 6.442 acres (total acres 236)  
 Price: See Phase II and Phase IV  
 Topography: level  
 Zoned: Light Industrial ([Zoning Ordinance](#))

### Water

Supplier: [Brainerd Public Utilities](#), (218) 829-8726  
 Source: Municipal Wells  
 Storage cap.: 3,400,000 gal.  
 Pumping cap.: 8,850 gal./minute  
 Ave. demand: 1,391,000 gal./day  
 Rates: \$205/mon charge + \$1.50/1000 gal.

### Wastewater

Supplier: [Brainerd Public Utilities](#), (218) 829-8726  
 Treatment Type: Mechanical Plant  
 Cap. of Plant: 3,130,000 gal./day  
 Average Demand: 2,400,000 gal./day  
 Peak Demand: 6,000,000 gal./day  
 Rates: \$2.10/1000 gal. for treatment + \$1 / 1000 gal. for collection + \$5/m on service charge AND \$25.50 mon. service debt charge

### Natural Gas

Supplier: [Minnegasco](#), (218) 829-4723  
[Northern States Power/Xcel Energy](#), (218) 828-1188  
 Size of nearest line: 3 inch

### Electricity

Supplier: [Brainerd Public Utilities](#), (218) 829-8726  
 Voltage available: 4,160 V - 34.5 KV, Phase 3 power  
 KW Transformer capacity up to 750 KVA

### Telecommunications

Supplier: Various ([see telecommunication page](#))  
 Services: Equal Access, Voice Mail, ISDN, Fiber Optics, Frame Relay, Video Conferencing, Local Internet Access, Centrex

### Transportation

Distance mjr hwy: MN 371 & MN 210 (.25 miles)  
 Access road load: 10 tons  
 Load factor in park: 10 tons  
 Distance to airport: 3 miles – Brainerd Lakes Regional Airport

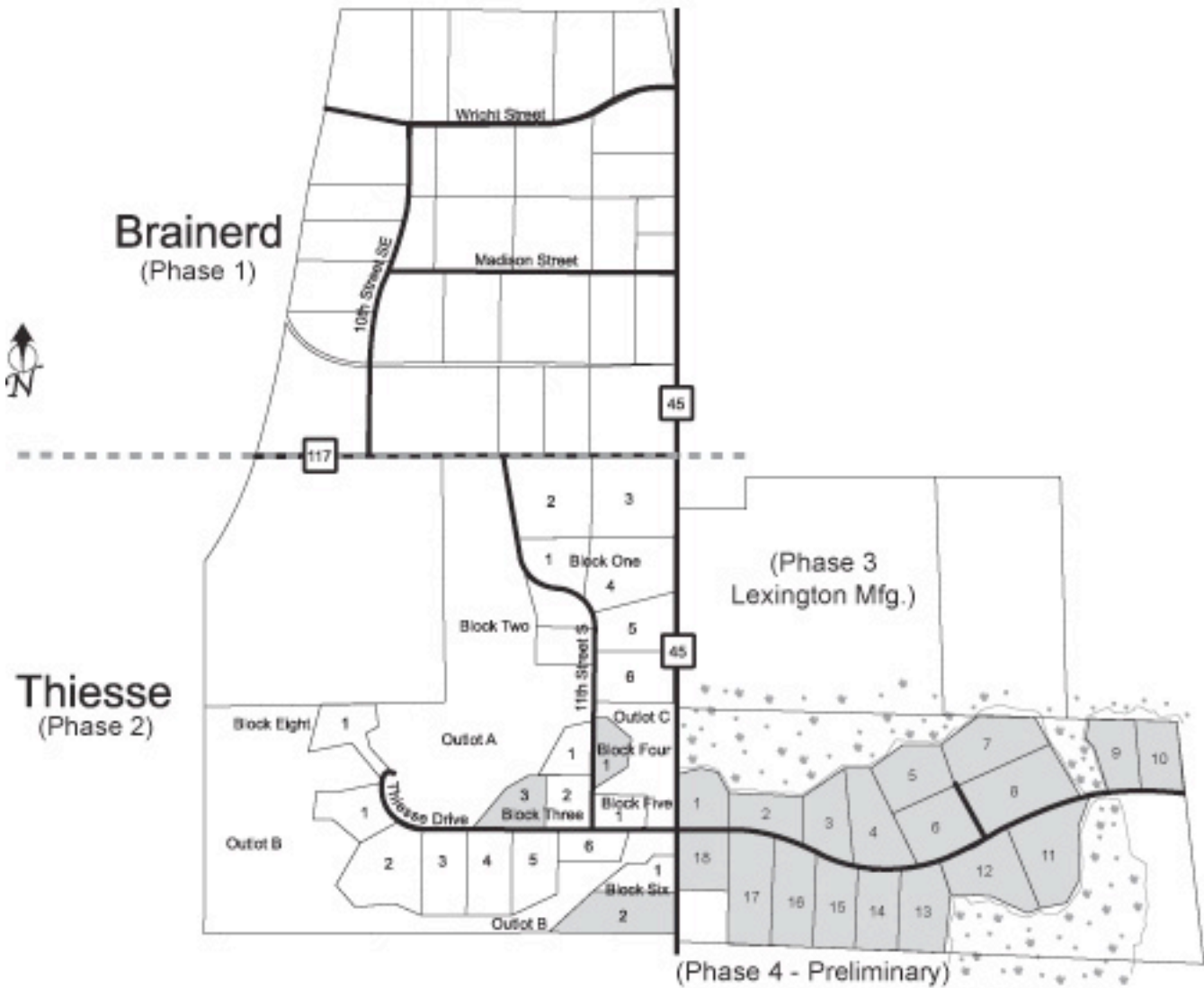

Shading on the map represents available lots.